

CUSTOMER NAME  
CUSTOMER Part No.

DATE	REV	DESCRIPTION	BY
2013. 01. 10	A/0		

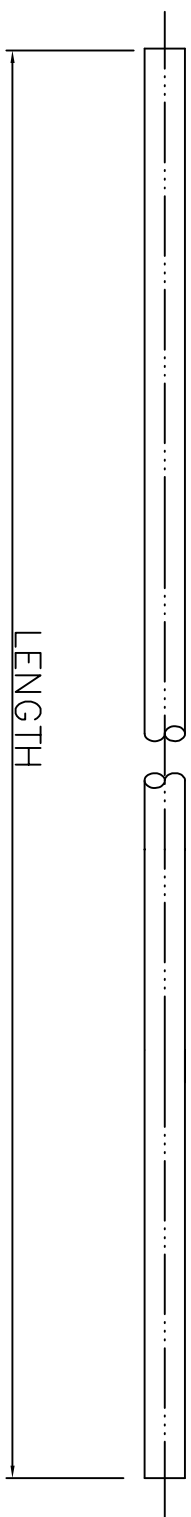

MARKING: ACT CATEGORY 6A UTP PATCH CABLE CONFORM TO ANSI/TIA-568-C.2 ▲ 24AWGX4P  
(FP0407) CMX(UL) c(UL) CMH E164469-F3 15000.001

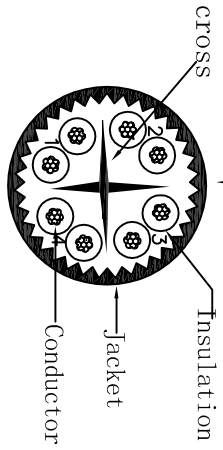

orange 2	green 3
white/orange	white/green
blue 1	brown 4
white/blue	white/brown

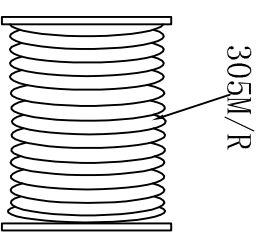

Item no.	Length	Colour	Packing
EP400B	305M	GRAY	Wooden drum
EP455B	305M	RED	Wooden drum
EP456B	305M	BLUE	Wooden drum
EP457B	305M	GREEN	Wooden drum
EP458B	305M	YELLOW	Wooden drum
EP459B	305M	BLACK	Wooden drum

<b>Conductor</b>	Bare Copper 24AWG
<b>Insulation</b>	Thickness:MIN at any point:0.2mm MAX AVG:0.3mm Diameter:1.03±0.06mm
<b>Jacket</b>	PVC Thickness:MIN at any point:0.55mm MAX AVG:0.75mm Diameter:7.0±0.15mm

<b>Wire</b>	CAT. 6A UTP STR 24AWGX4P
<b>Length</b>	305M
<b>Color=YY</b>	YY



PAGE	1/1	Part No. EP4XXB	
Key Size	A	Description	CAT. 6A UTP (with Cross) STR 24AWG*4P
ROHS COMPLIANT		DEP. R&D	APPROVAL
Unless specified on the drawing, tolerances are per the follows:		SCALE	CHECKER
.x	± 0.5	UNIT	mm
.xx	± 0.1		
3RD	± 0.05		
			DHY